

10. Unemployment
Period provided for: 2008
Page: 40

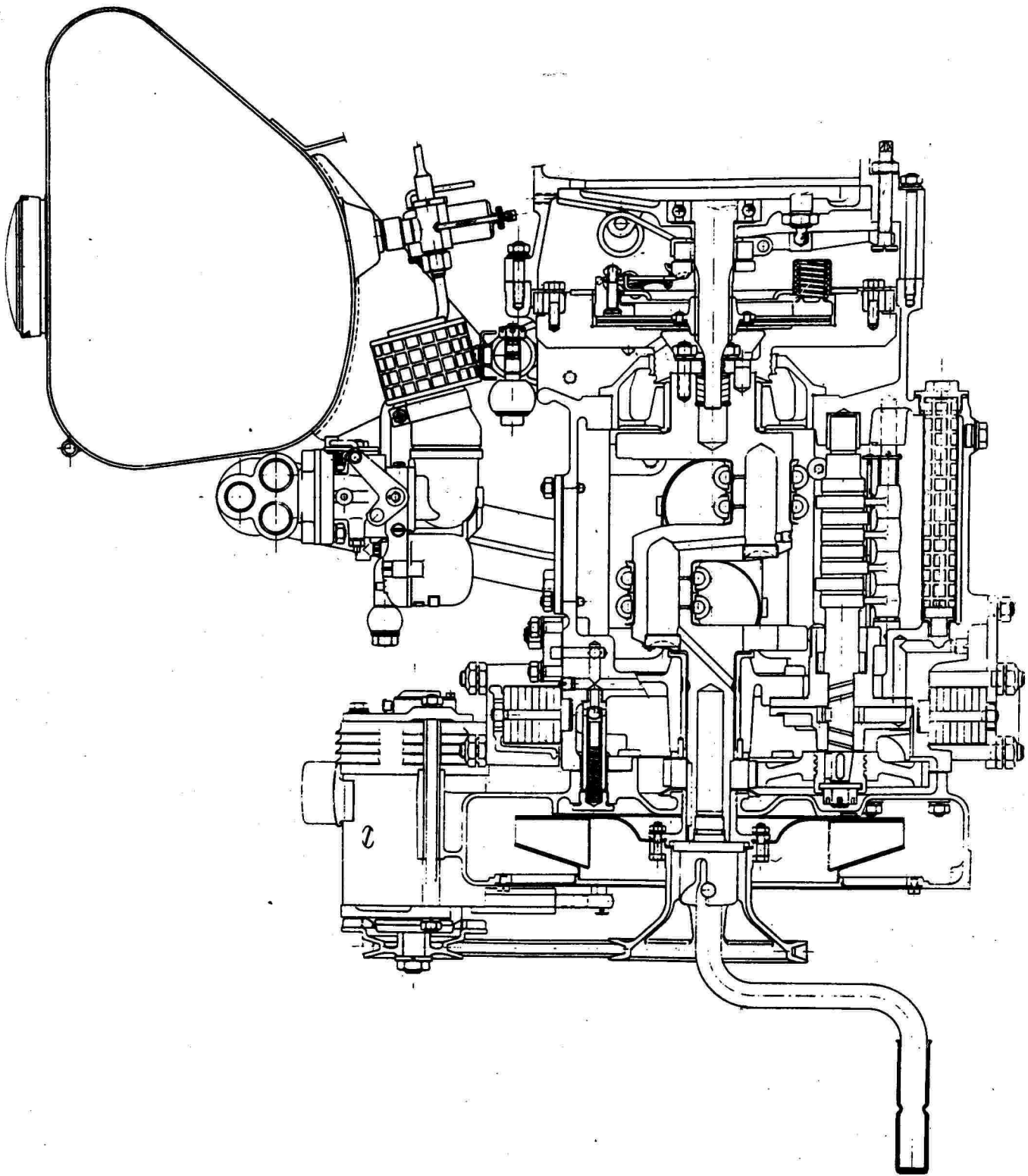

6017

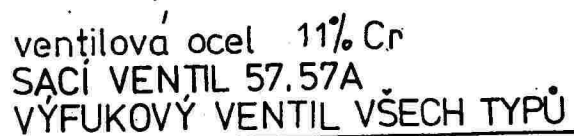

t.č. 570410

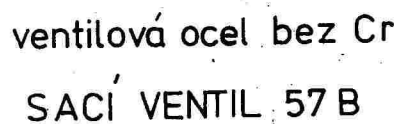

t.č. 570431

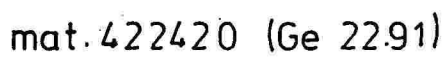

VEDENI VENTILU

t.č. 570404

t.č. 5703 27

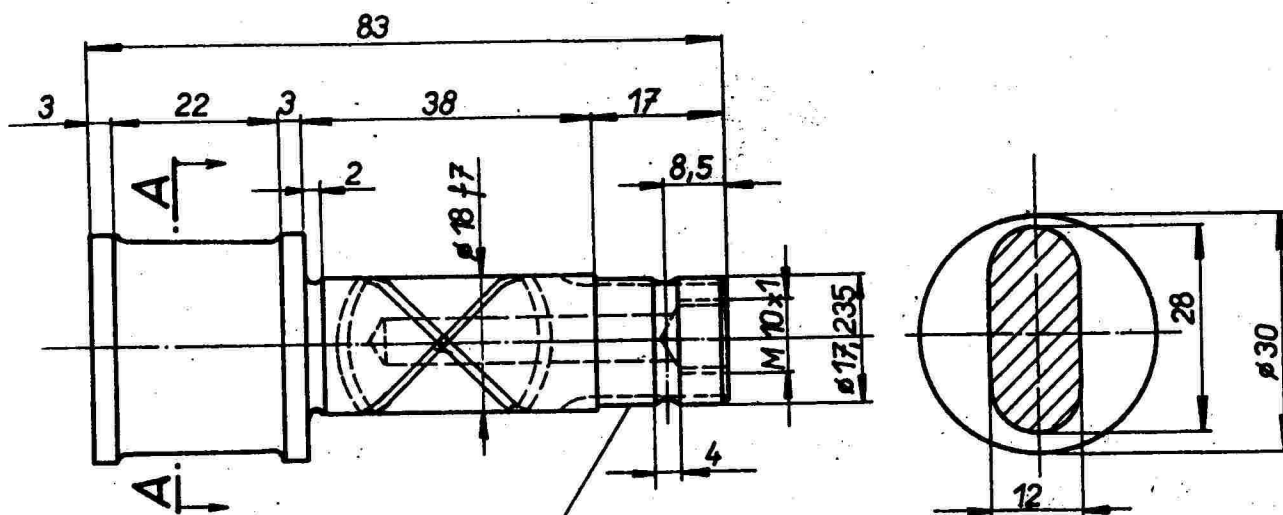

BRZDOVÝ KLÍČ

MAT.: 11 425

V.Č. 57 3405

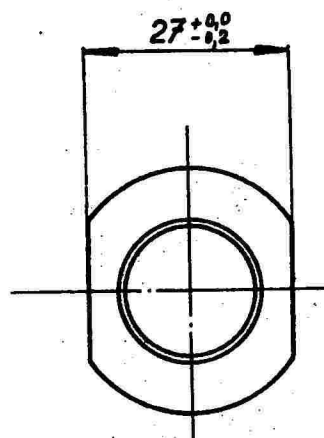
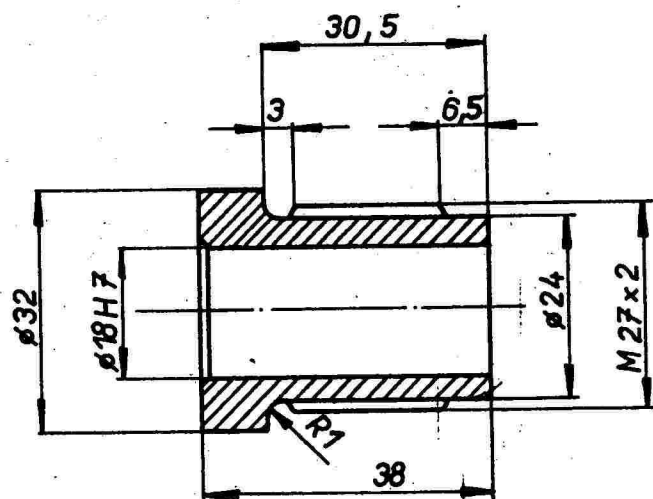

POUZDRO PRO BRZD. KLÍČ

MAT.: MOSAZ

V.Č. 57 4213

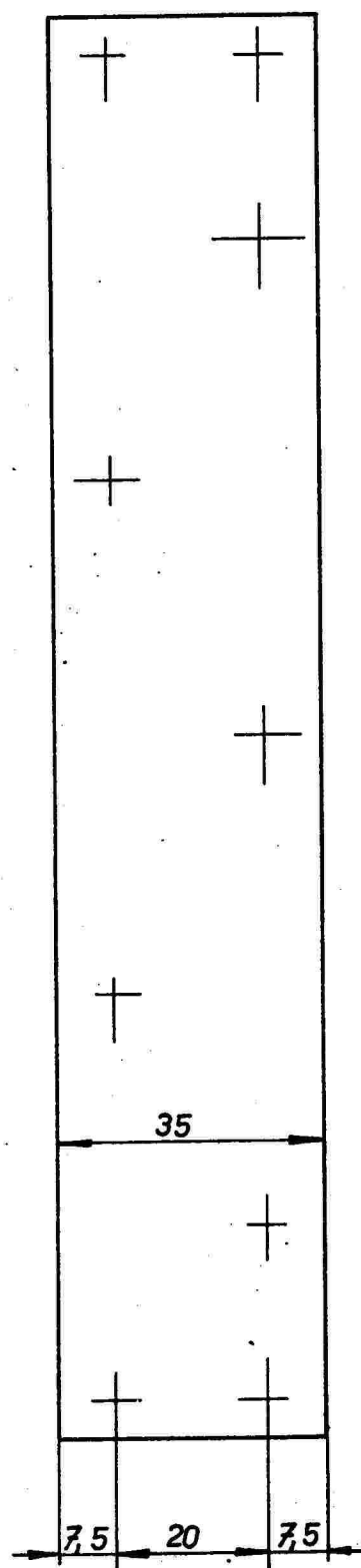

ROZVINUTÁ DÉLKA 222

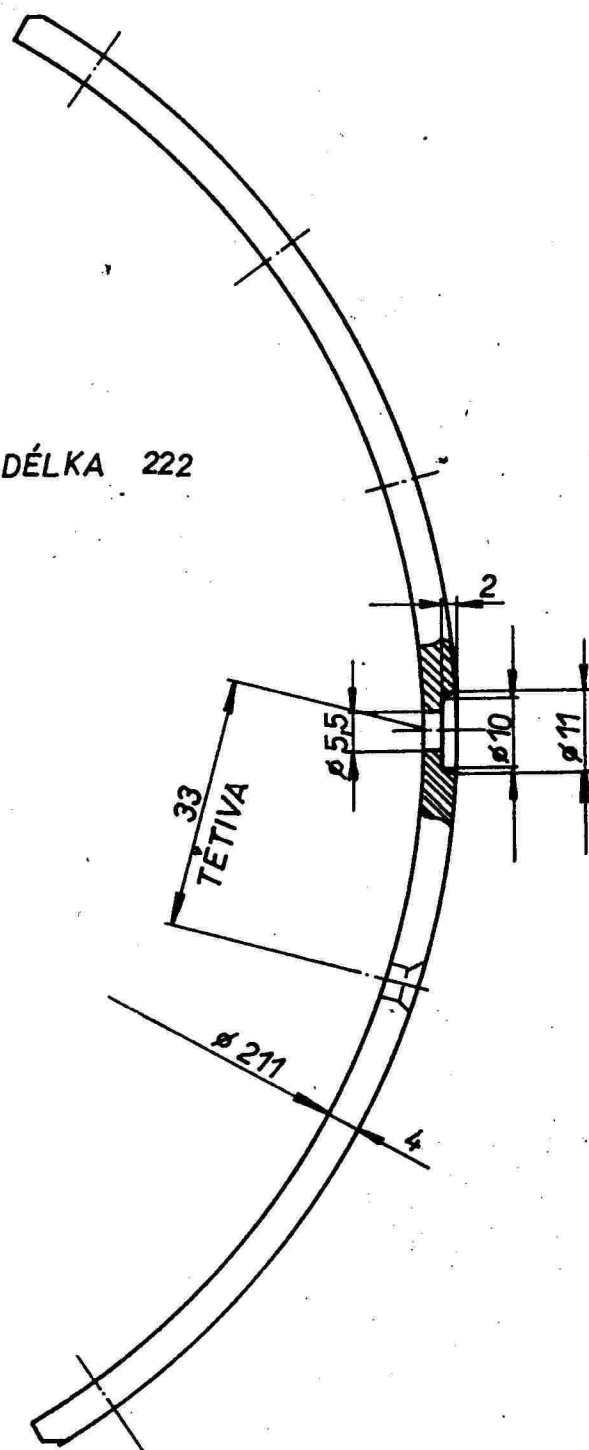

BRZDOVÉ OBLOŽENÍ

V. Č. 57 3404

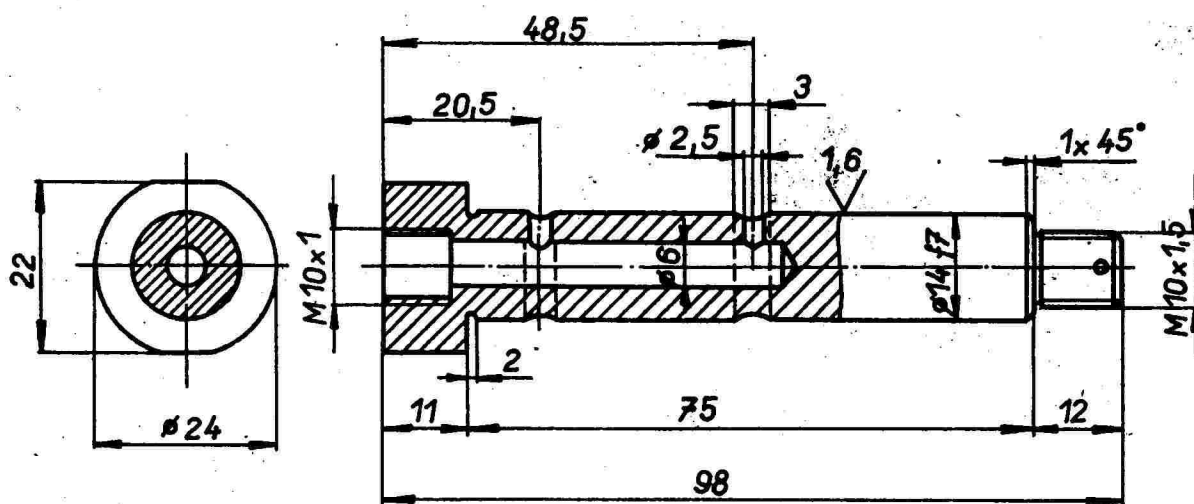

ČEP PŘEDNÍHO PERA - HORNÍ

MAT. : 14 220.1

V.Č. 75 4171

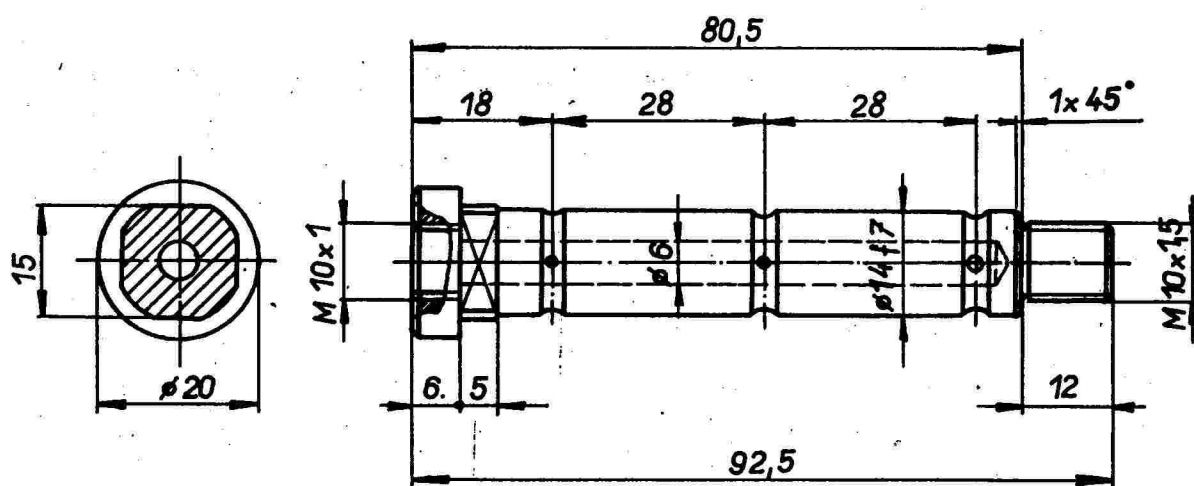

ČEP PŘEDNÍHO PERA SPODNÍ

MAT. : 14 220.1

Č.V. 75 4172



ŘEZ A-A

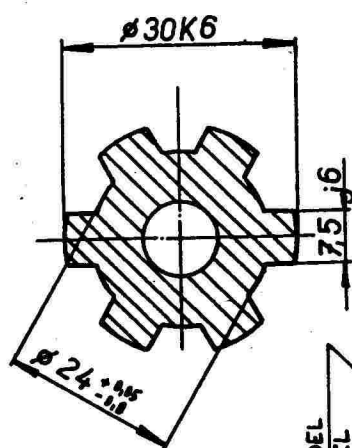

DETAIL „A“

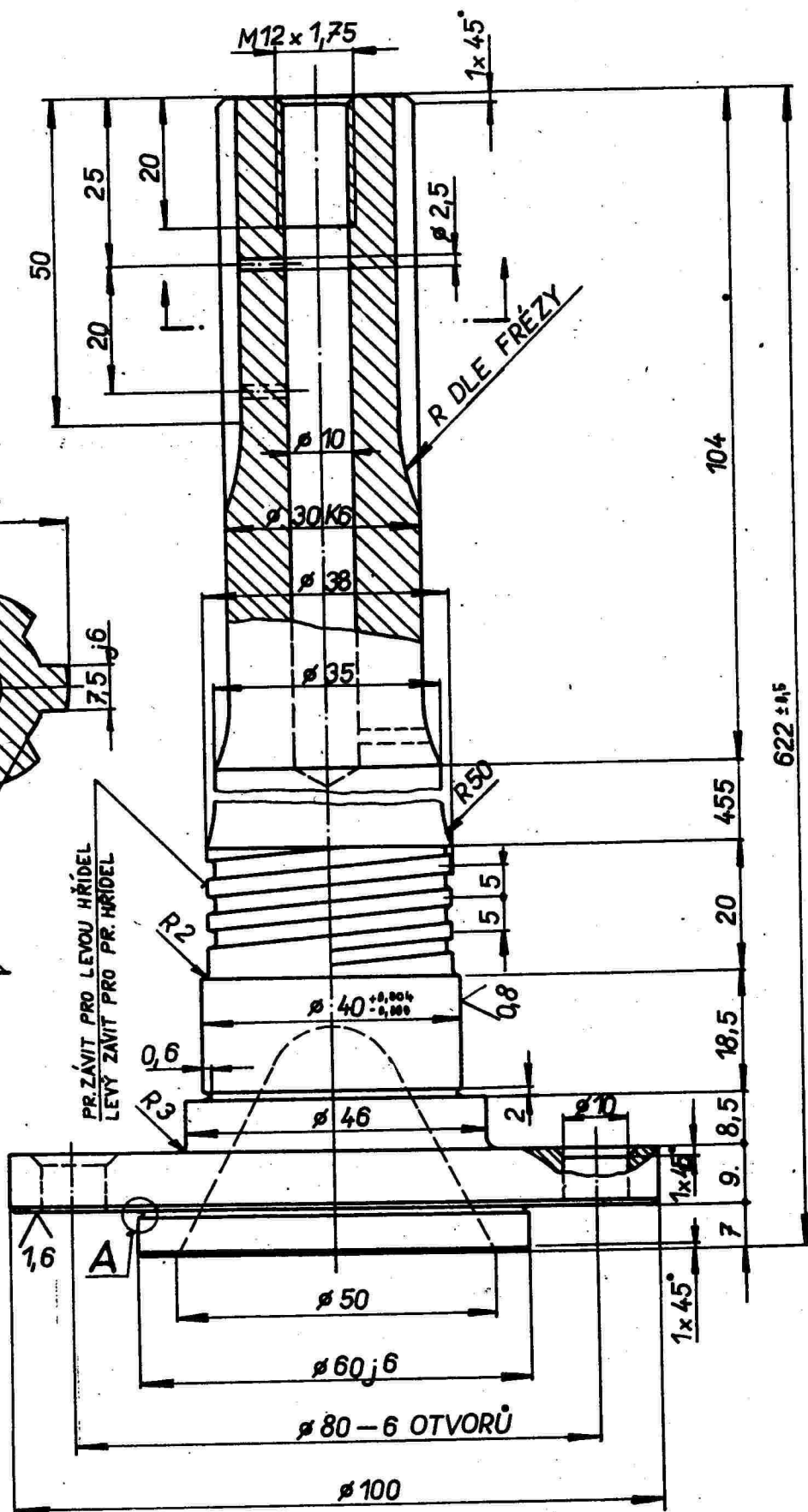
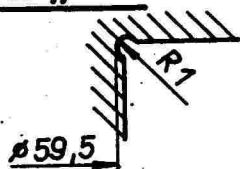

HŘÍDEL ZADNÍ OSY
MAT. 13 240

V. Č. 57 3448 (49)

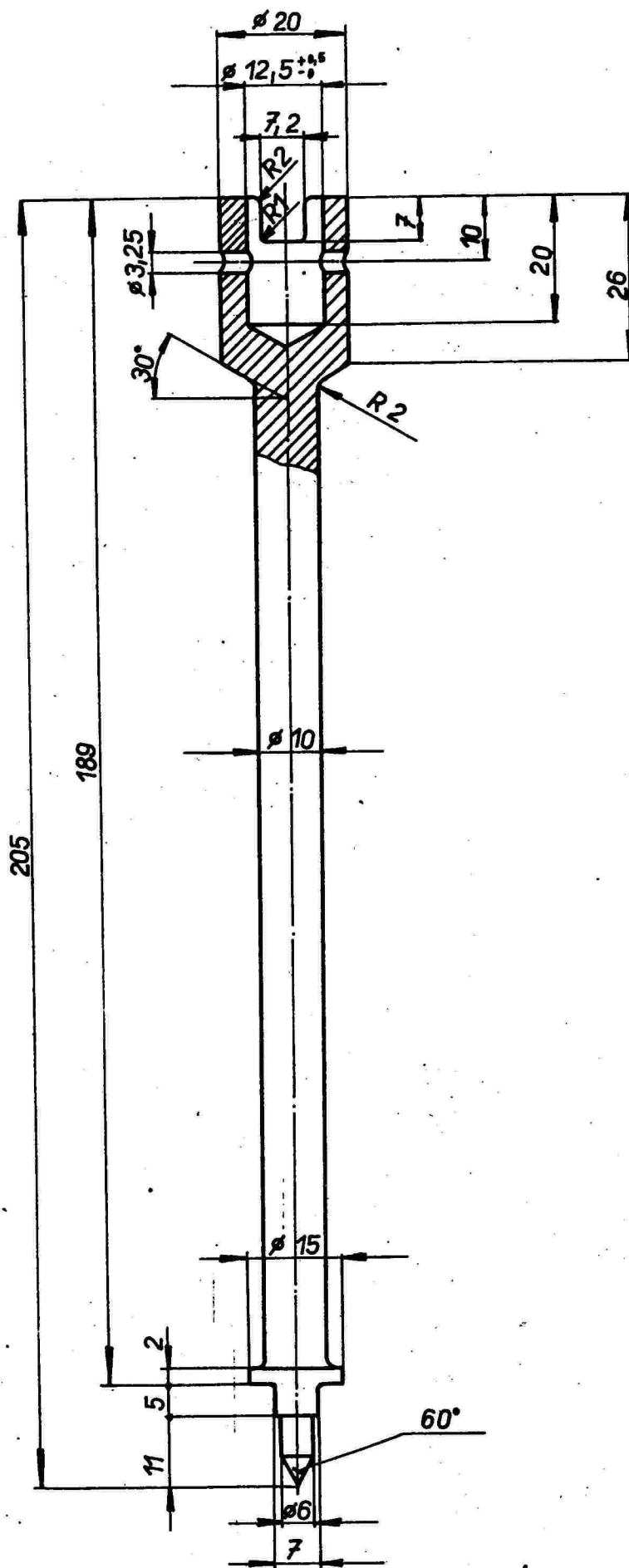

HŘÍDEL ROZDĚLOVAČE
MAT.: 11 700

V. Č. 75 0911

DETAIL DRÁŽKY

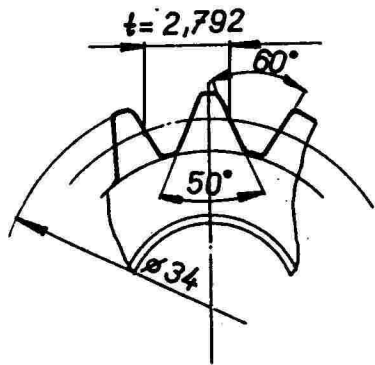

POČET ZUBŮ - 34

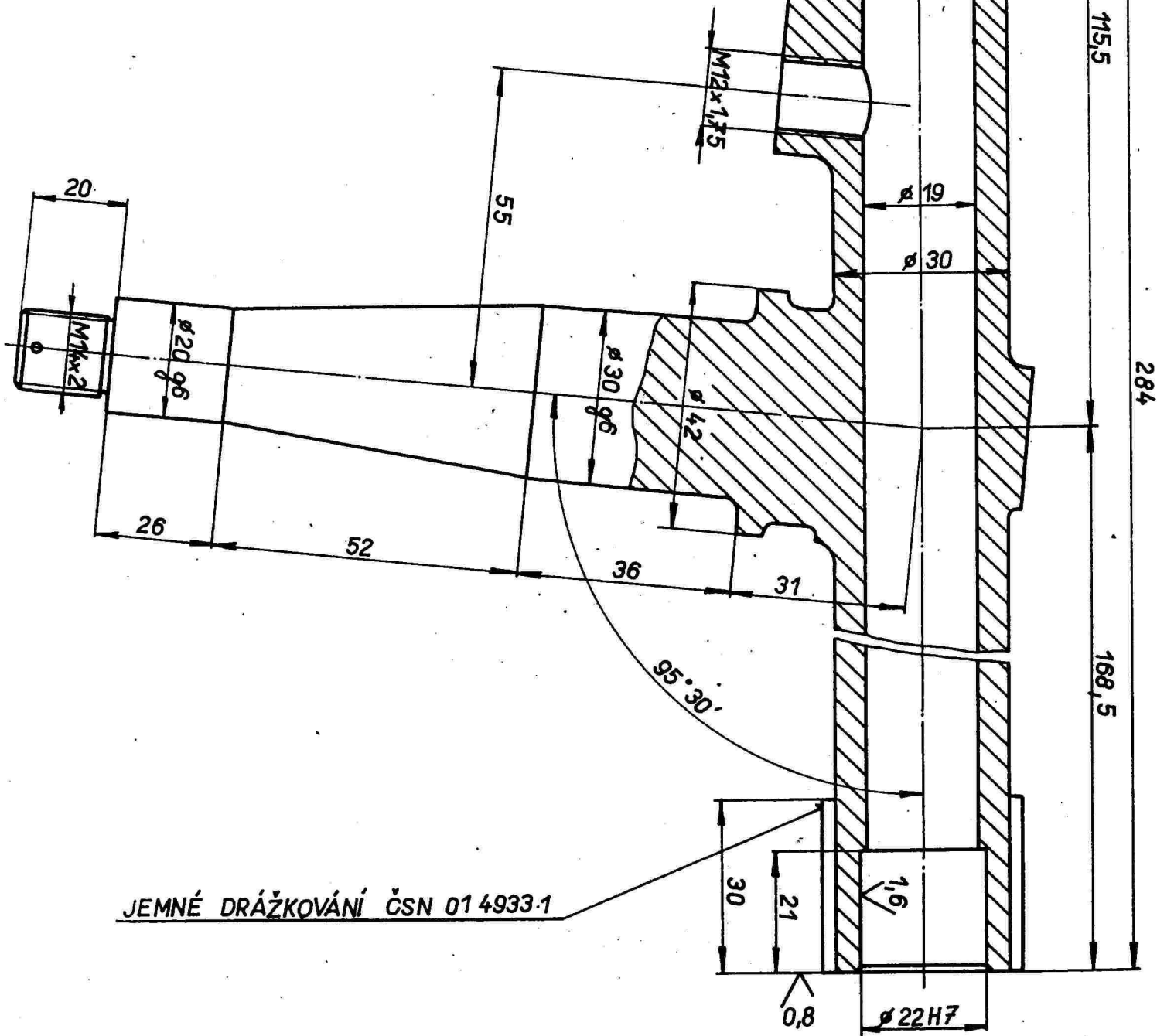

OTOČNÝ ČEP—T 57; 57A; 57B

V.Č. 57 4165

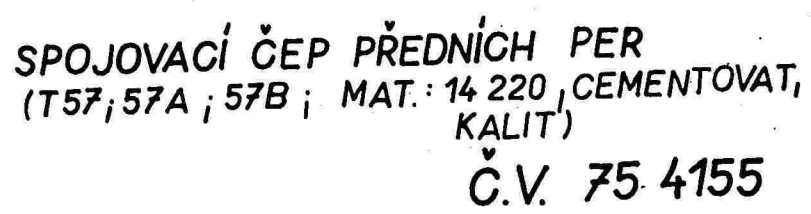

Č.V. 75.4155

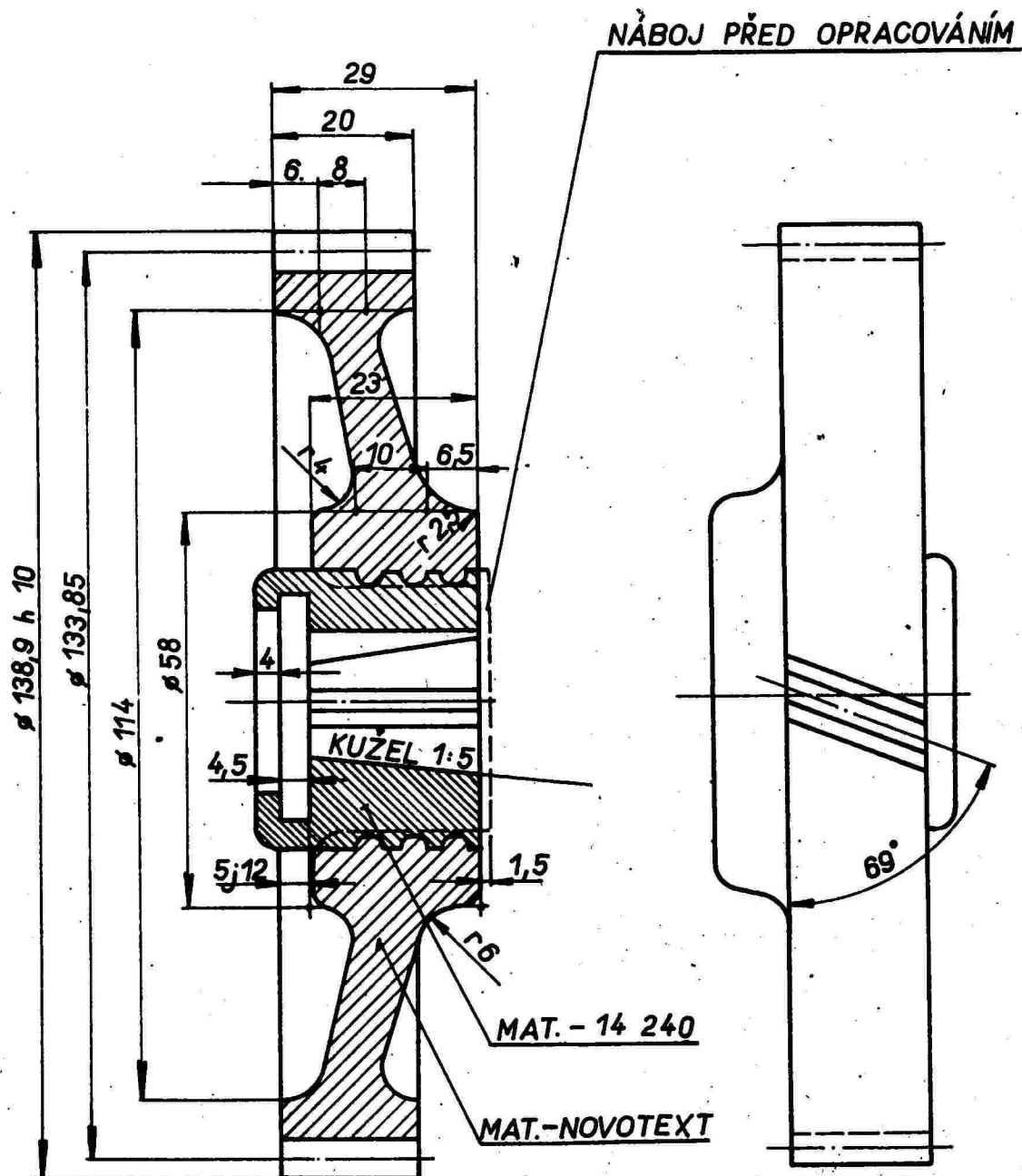

OZUBENÍ	EVOLVENTNÍ
ZUBY	ŠIKMÉ
POČ. ZUBŮ	50
MODUL	2,5
ÚHEL ZÁBĚRU	15°

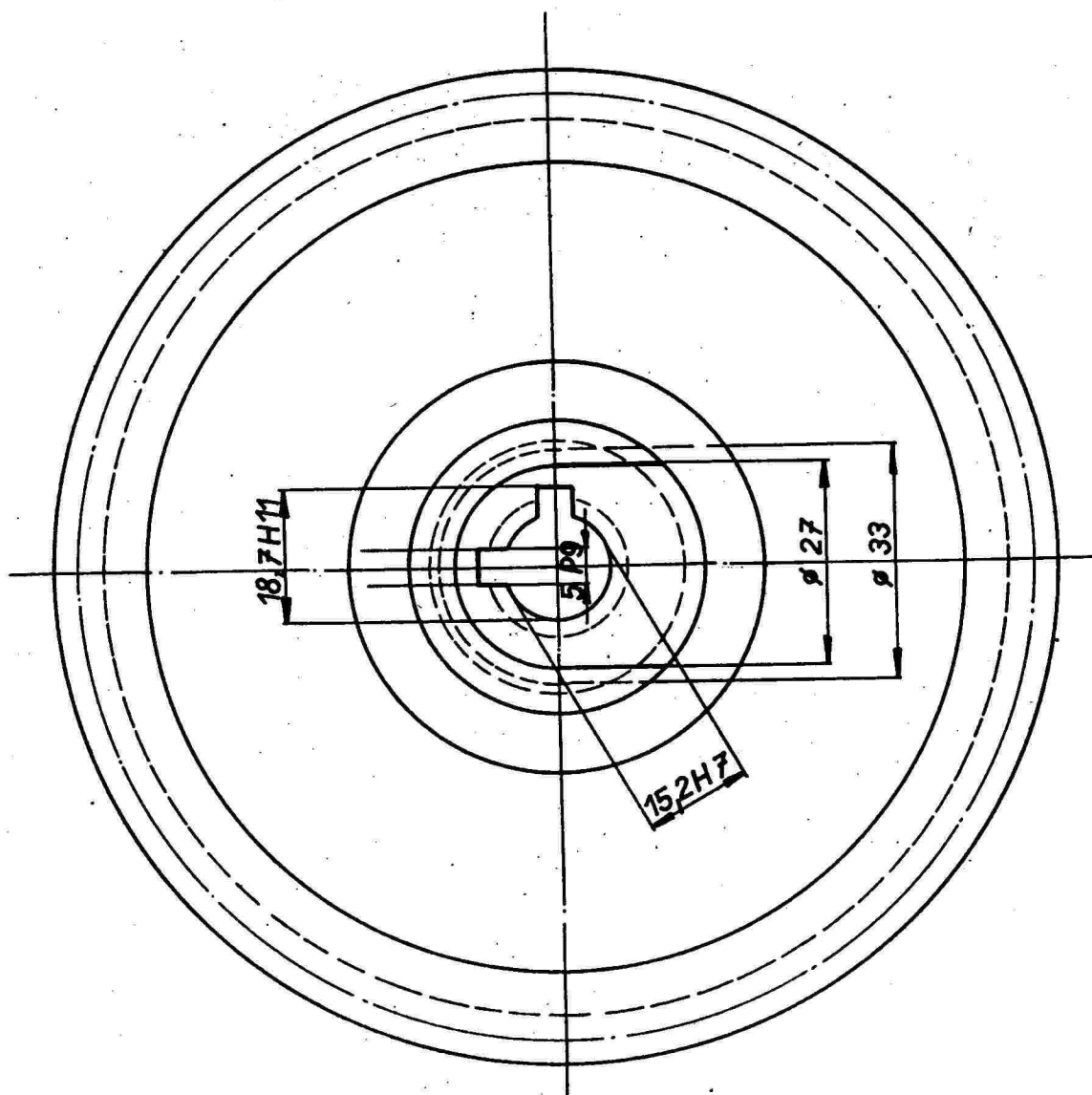

ŠROUBOVÉ KOLO T 57, 57A, 57B

Č.V. 57.05.48

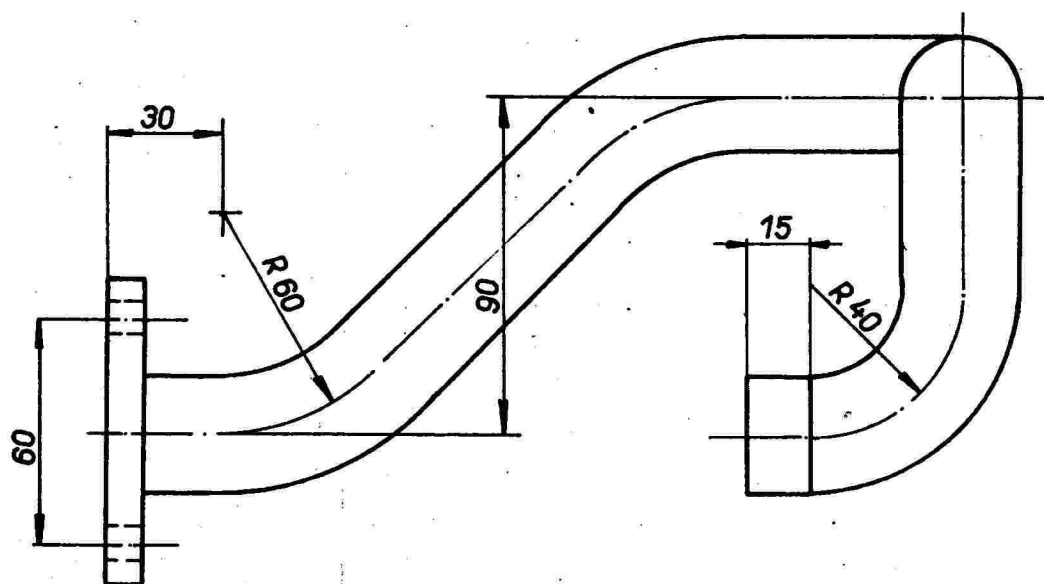
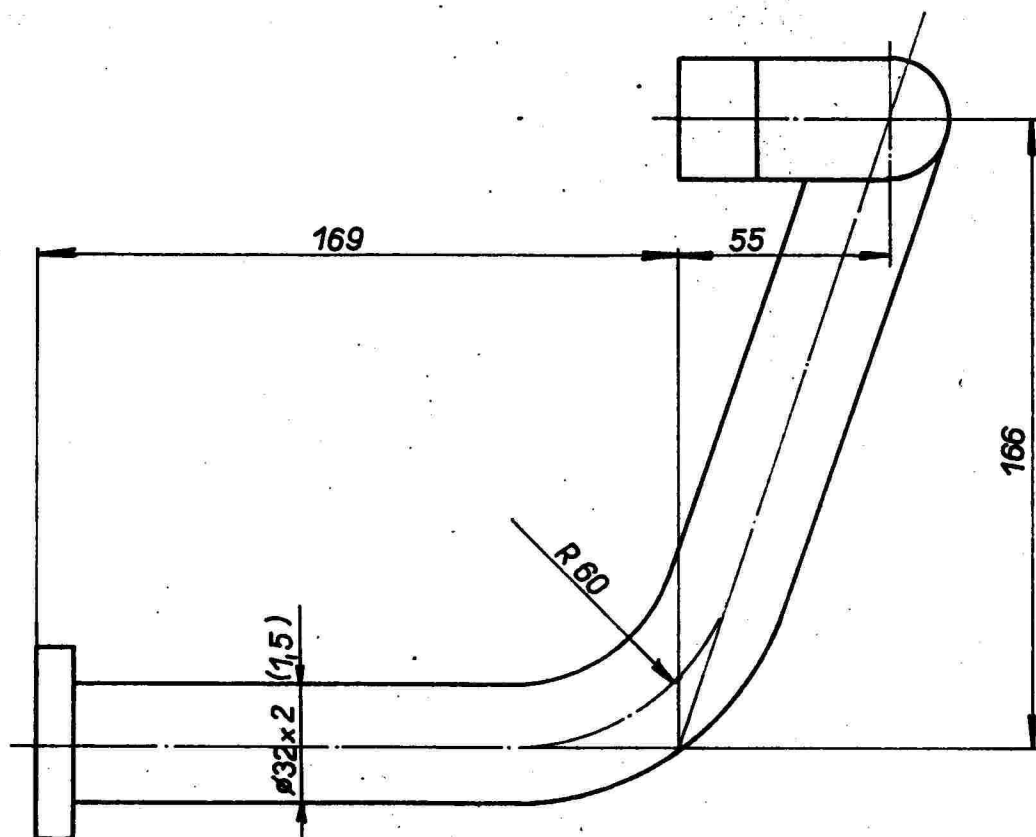

KOLENO VÝFUKOVÉHO POTRUBÍ - LEVÉ
(PRAVÉ JE ZRCADLOVÝ OBRAZ) - T 57 B

V.Č. 57 1194

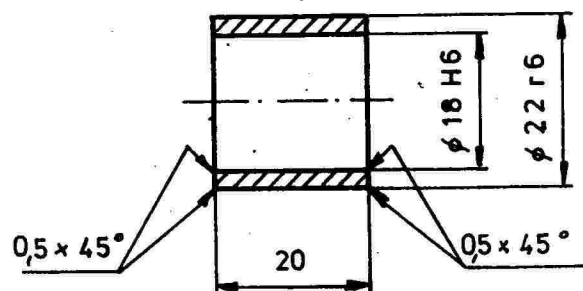

mat. BRONZ

VLOŽKA SMĚLÉHO ČEPU
v.č. 57415 3

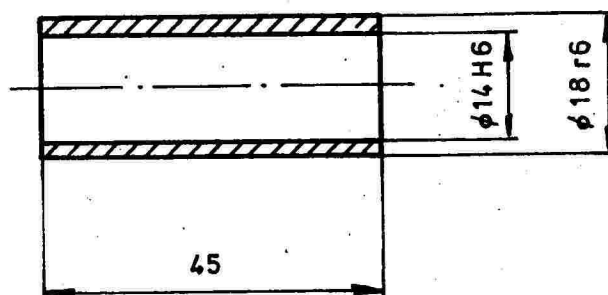

mat. BRONZ

POUZDRO PŘEDNÍHO PERA
v.č. 514157

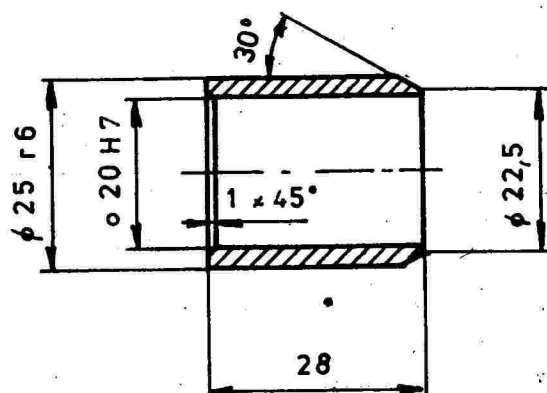

mat. 422420

VLOŽKA PRO VÁČKOVOU HŘÍDEL
v.č. 570143

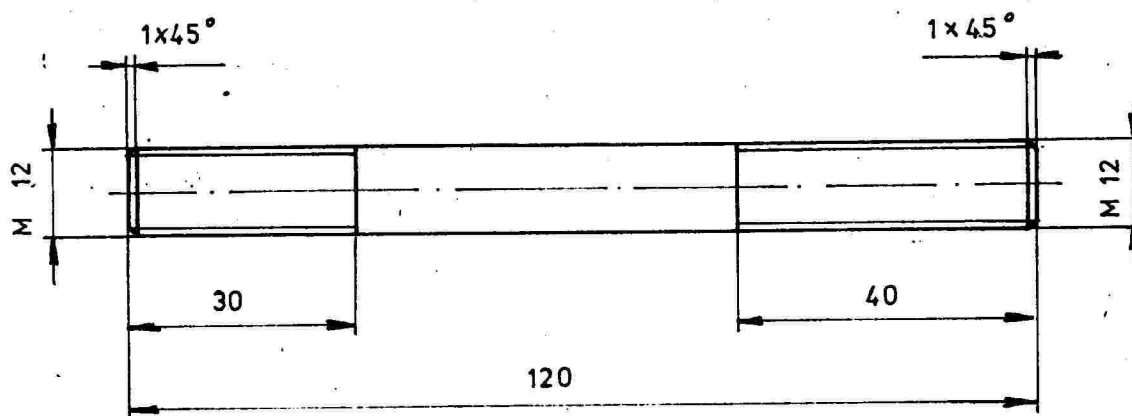

mat. 14220

ŠROUB ZADNÍHO PERA

v.č. 575333.02

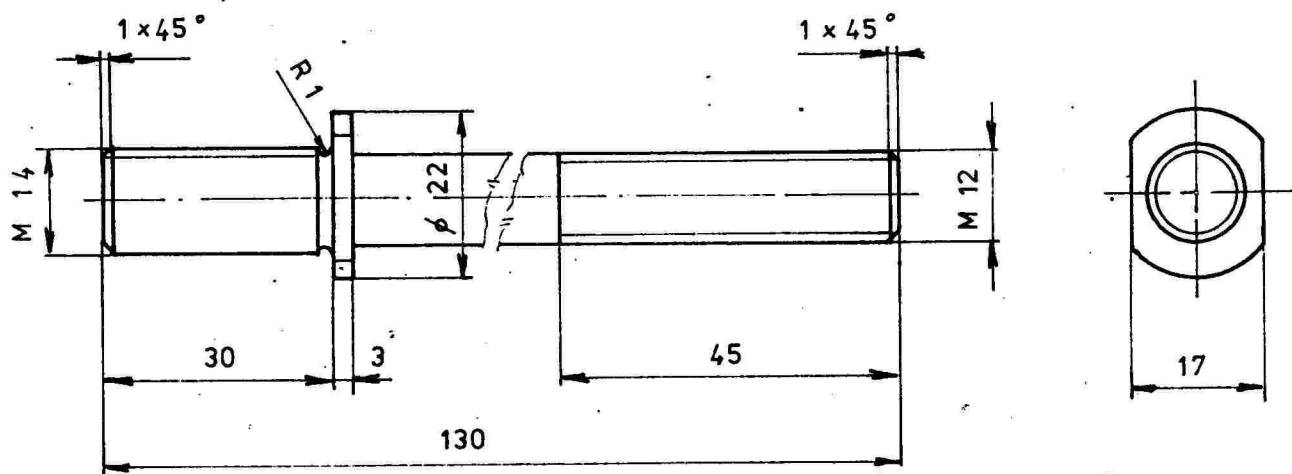

mat. 14220

ŠROUB ZADNÍHO PERA

ZESÍLENÝ PO VYTRŽENÍ

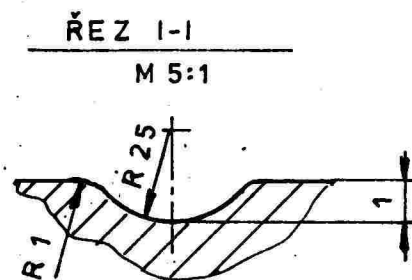
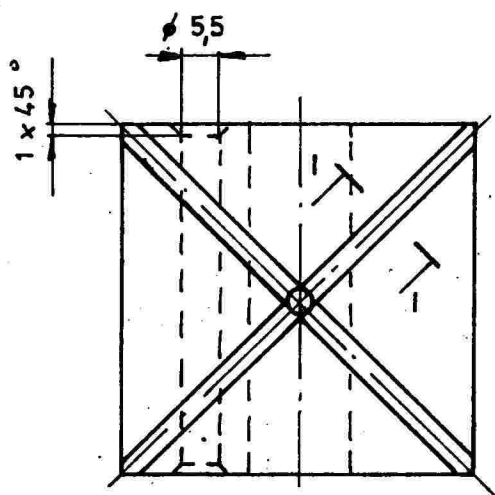
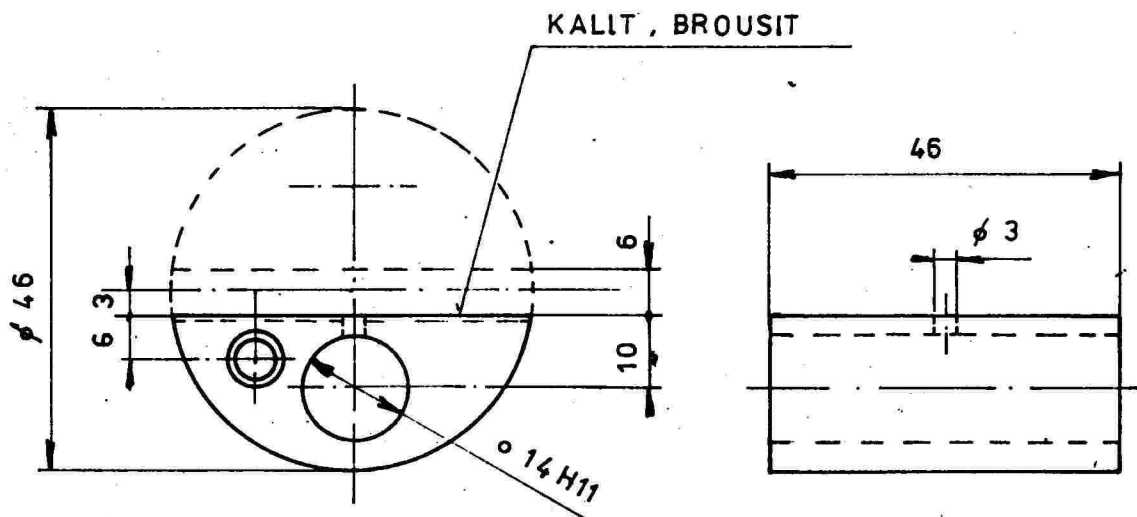

mat. 12020.1

OPĚRNÁ DESKA ZADNÍHO PERA
v.č. 573409

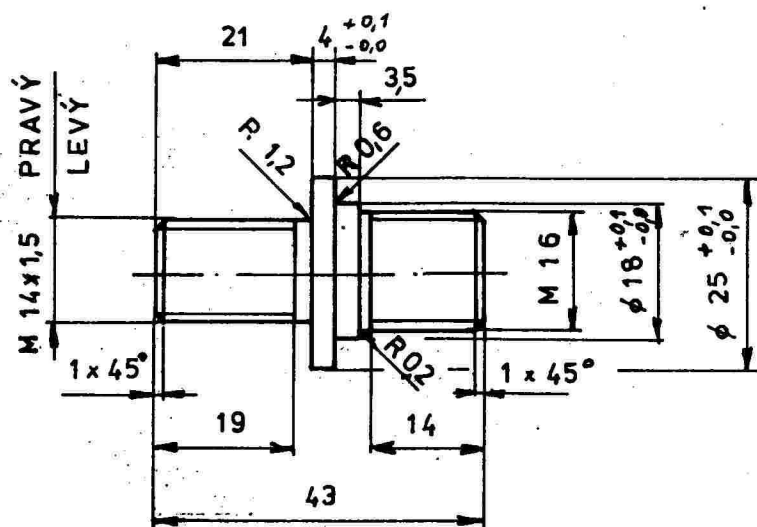

mat. 14220

ŠROUB KOLA
v.č. 114 210
11

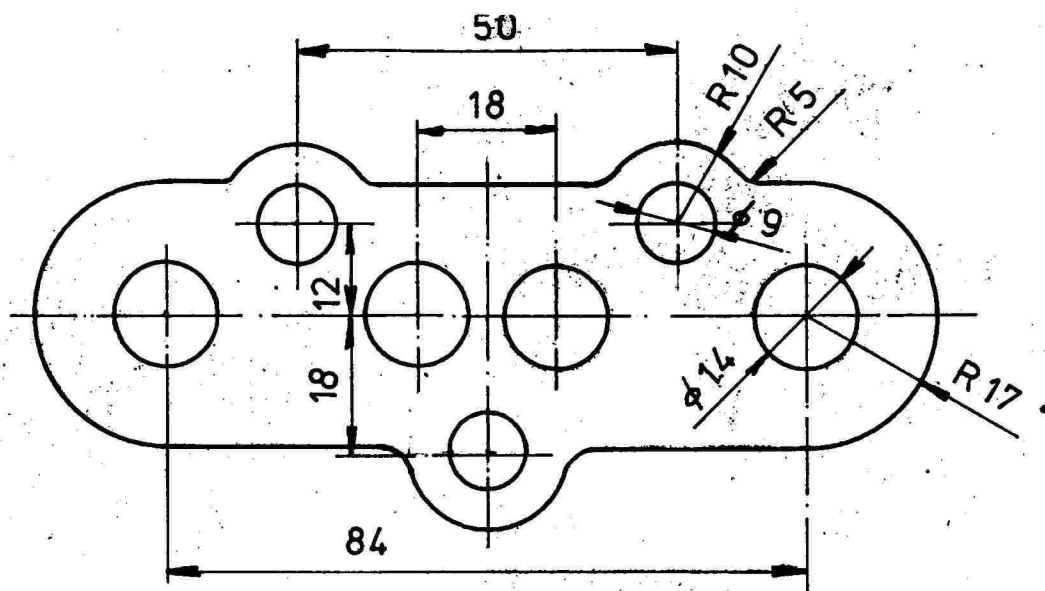

TĚSNĚNÍ POD HLAVU – PAPIR

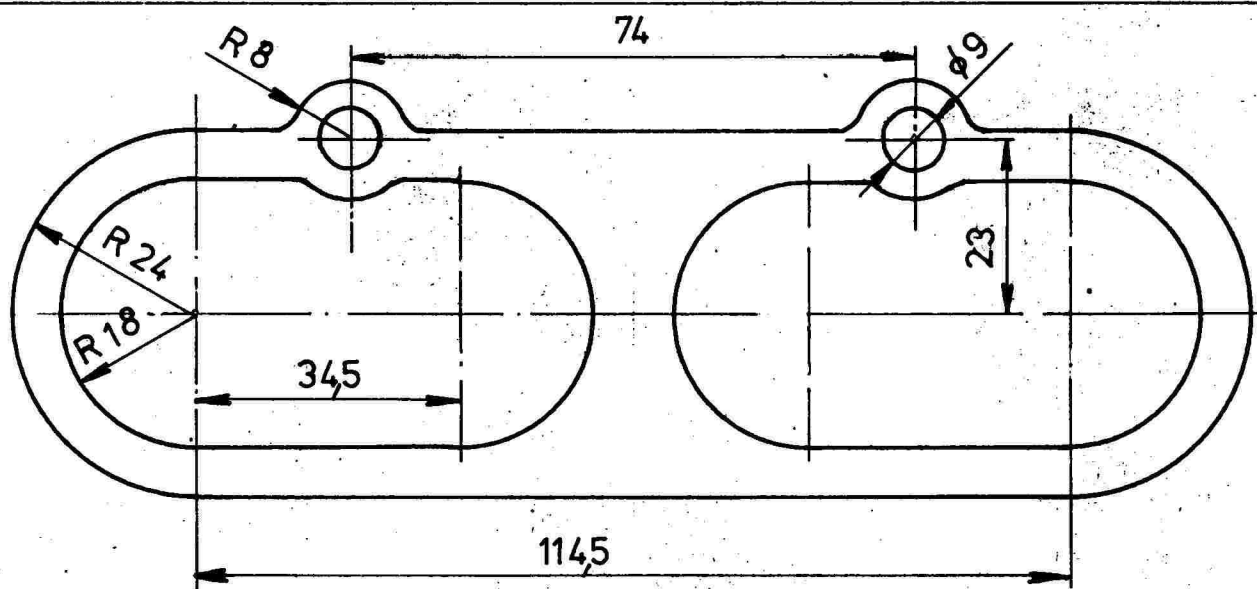

TĚSNĚNÍ POD HLAVU – PAPIR

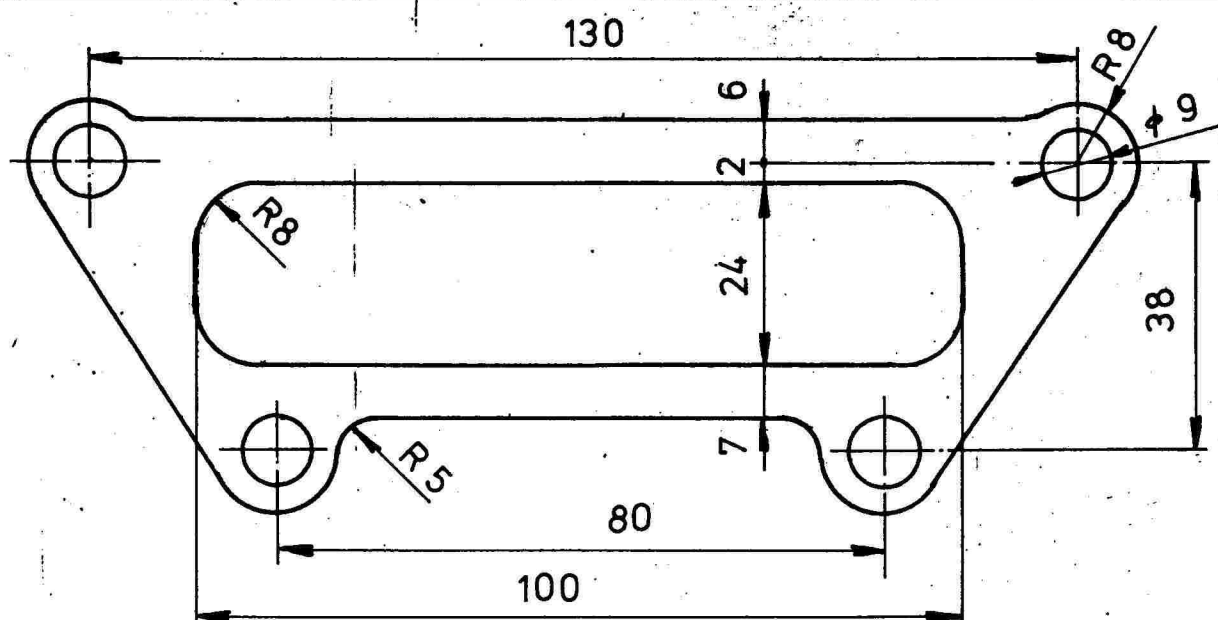

TĚSNĚNÍ POD KRYT. ROZVOD. TYČEK – PAPIR

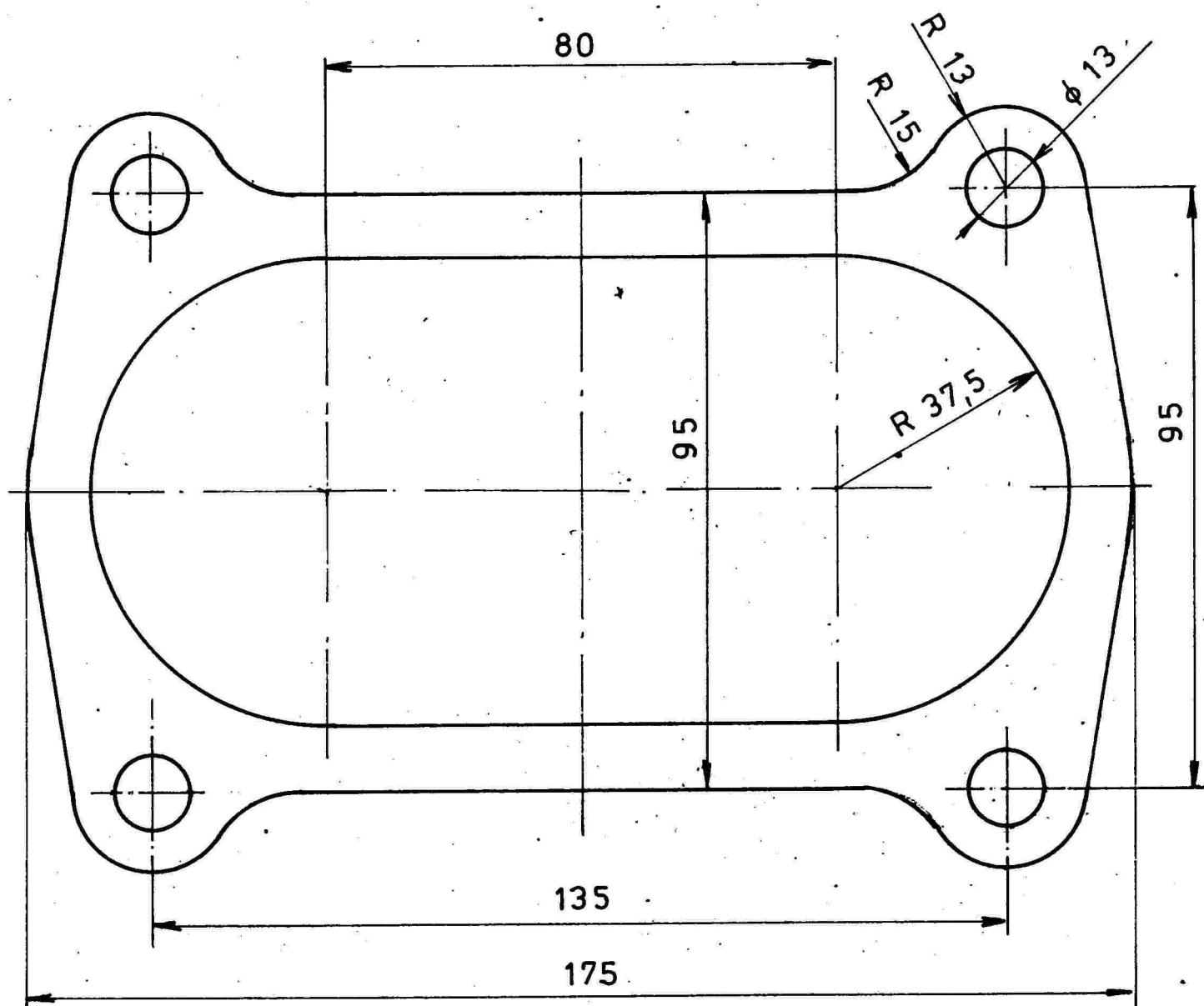

mat. PAPIR

TĚSNĚNÍ POD VÁLCE

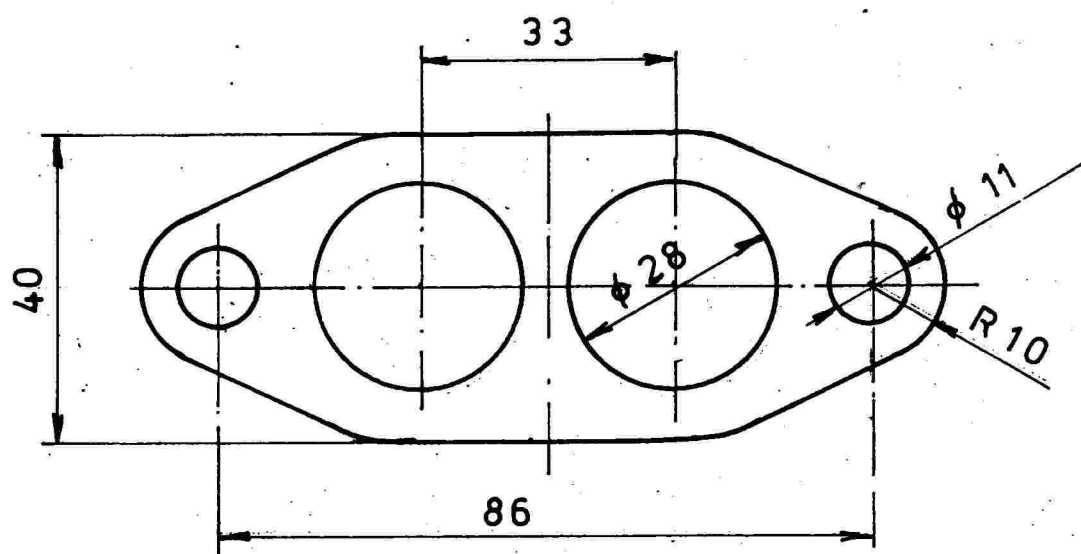

mat. KLINGERIT

TĚSNĚNÍ POD SACÍ ROUR Y

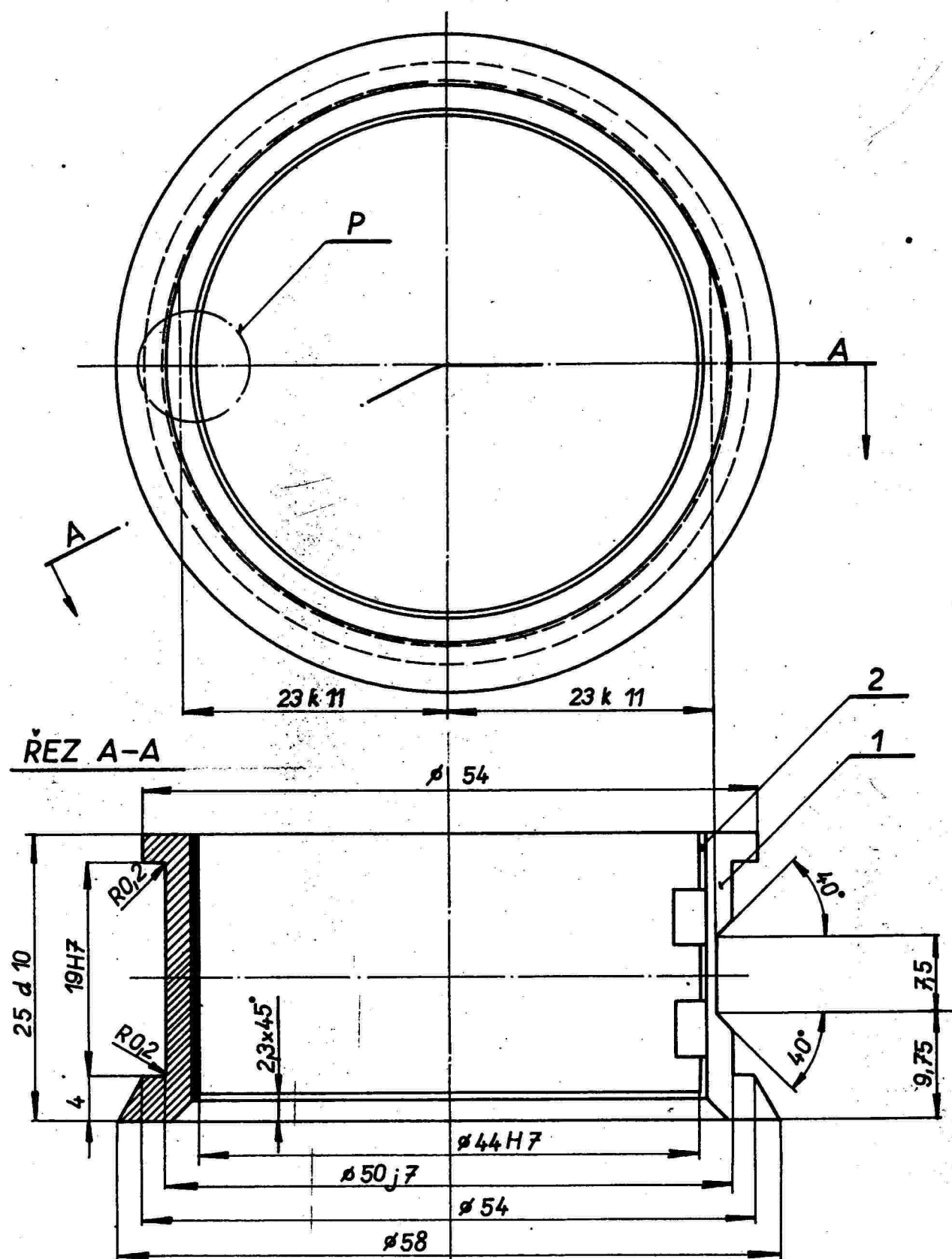

LOŽISKOVÁ PÁNEV K OJNICI-T57B

Č.V. 57. 03. 07 K₁

